PCM301 Isolation Explosion-proof Pressure Transmitter



- Piezoresistive silicon chip employed
- MEMS technology
- EXIA IIC T6

PCM301 is designed for hazardous area application. It is used for explosion-proof industry widely.

Advantages

Hazardous area application
Isolation explosion-proof
Good long term stability
Excellent linearity

Pressure range	
Pressure range	-100Kpa,10kPa, 35kPa, 70kPa, 100kPa, 250kPa, 400kPa, 600kPa, 1MPa, 1.6MPa, 2.5MPa, 4MPa, 6MPa, 10MPa, 16MPa, 25MPa, 40MPa, 60MPa, 100MPa
Pressure reference	Gauge pressure Absolute pressure Sealed gauge pressure
Overpressure	200%F.S.($<25\text{Mpa}$) 150%F.S.($\geq 25\text{Mpa}$)
Output signal	
Output	4 to 20mA (Typical) 1 to 5V 0 to 5V
Specification	
Accuracy (linearity, repeatability and hysteresis)	$\pm 0.5\%$ F.S. (Typical)
Excitation	24VDC 12 VDC
Compensated temp.	-10-70°C(typical)
Operating temp.	-20-80°C
Storage temp.	-40-125°C
Zero temp. coefficient	$\pm 1.5\%$ F.S.max.
Span temp. coefficient	$\pm 1.5\%$ F.S.max.
Pressure connection	see last page "how to order"
Protection	IP68
Housing material	Stainless steel 304 (SS316 for sensor inside)
Long-term Stability	$\leq 0.2\%$ F.S./year
Isolation Ex-proof	EXIA IIC T6

Drawing

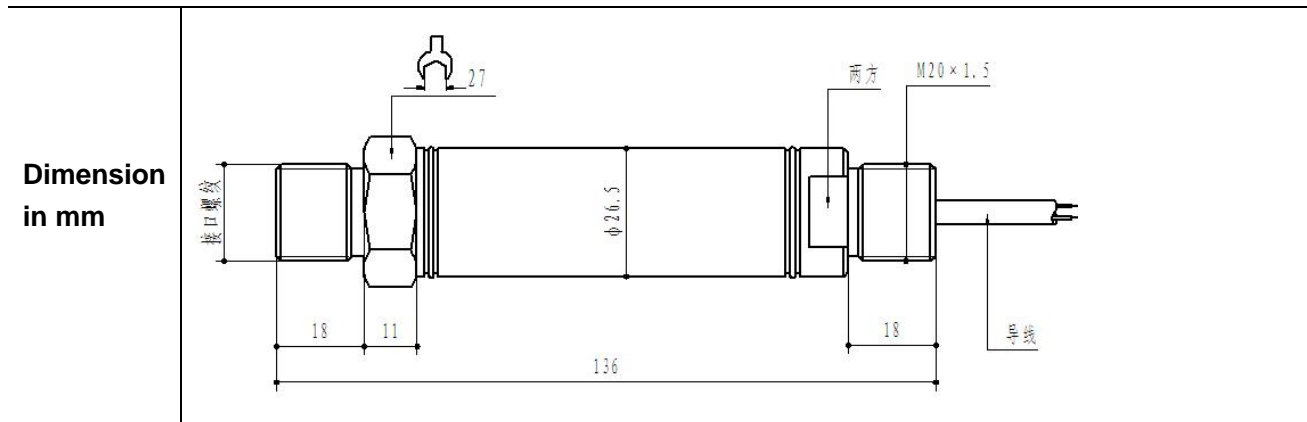

Pressure port

Type	C1: M20x1.5	C2: G1/2	C3: M14x1.5	C4: G1/4
Dimension in mm	<p>Diagram of pressure port C1. Dimensions: 25 mm (total height), 15 mm (height to the top of the hexagonal part), and M20 x 1.5 (thread specification).</p>	<p>Diagram of pressure port C2. Dimensions: 25 mm (total height), 15 mm (height to the top of the hexagonal part), and G1/2 (thread specification).</p>	<p>Diagram of pressure port C3. Dimensions: 25 mm (total height), 15 mm (height to the top of the hexagonal part), and M14 x 1.5 (thread specification).</p>	<p>Diagram of pressure port C4. Dimensions: 25 mm (total height), 15 mm (height to the top of the hexagonal part), and G1/4 (thread specification).</p>

How to order

PCM301 XX—XX—XX

Pressure range

Please write directly

Pressure reference

A: absolute pressure

G: gauge pressure

S: sealed gauge pressure

Pressure connection

C1: M20*1.5

C2: G1/2

C3: M14*1.5

C4: G1/4

C5: others (please specify)